

# Glenview

## Newsletter

Village of Glenview  
1225 Waukegan Road  
Glenview IL 60025

CAR-RT-SORT  
BULK RATE  
U.S. POSTAGE  
**PAID**  
Glenview, IL  
Permit No. 177

To:  
Postal Customer

Dec. '86 - Jan. '87

## Elderly Housing Complex started



**Above:** Architect's elevation sketch of the Glenview Elderly Housing Complex, as it would be seen when looking southeast from the corner of Harlem

**Below:** Avenue and Glenview Road. The revised site plan, similar to the proposed site plan published here in October-November, 1984.

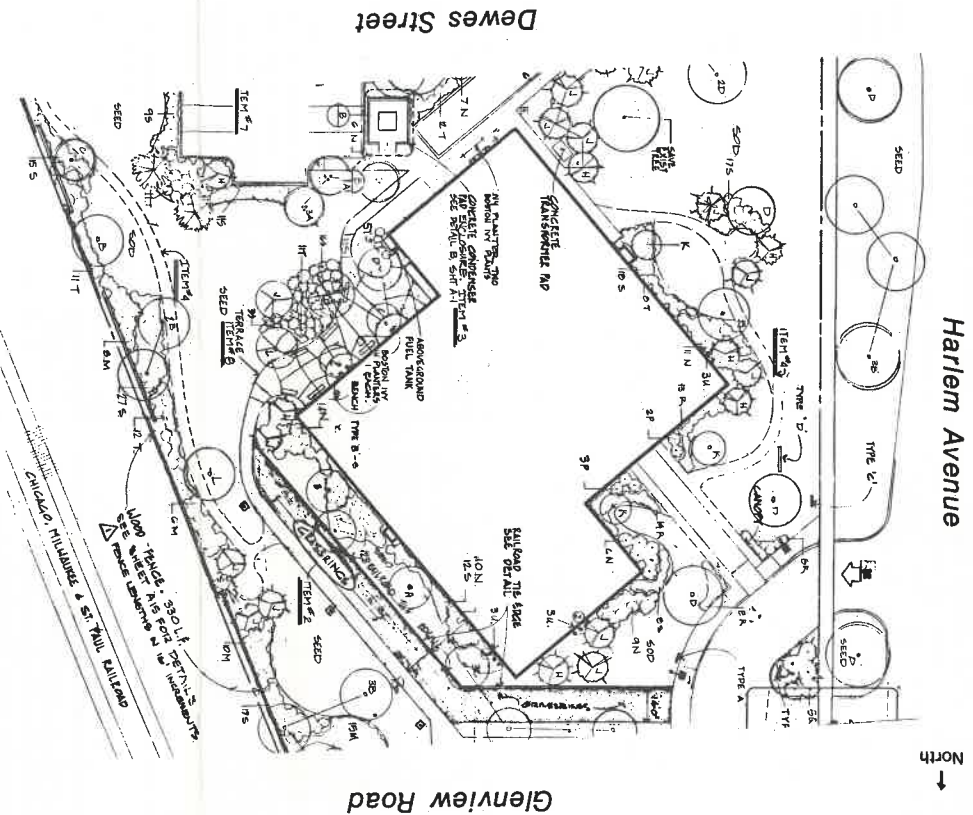

**C**onstruction of the 5-story, 80-unit Glenview Elderly Housing Complex, which will be underway as soon as final clearance is received from Washington D.C. (possibly before you receive this newsletter), will be at the southeast corner of Glenview Road and Harlem Avenue.

To be built with the assistance of a \$4.55 million loan from the Department of Housing and Urban Development, the complex will be managed by Evangelical Health Systems of Oak Brook, which maintain similar facilities in Downers Grove and Barrington.

Included will be 48 1-bedroom apartments, 23 efficiency units, 4 handicapped units, and 5 wheelchair models, each equipped with range and refrigerator. The building will also

have a community dining room, kitchen, atrium, and game and craft rooms.

Designed in conformance with the Illinois Capital Development Board's standards of accessibility, the residence will be adjacent to train and bus transportation, the Glenview Public Library, shopping facilities, and very close to the Glenview Fire Department paramedic service.

Construction work is by A. J. Maggioro of Mt. Prospect, and is expected to be complete by this time next year.

Applications, rental costs, and criteria for eligibility are not yet available. Please watch future issues of this newsletter for further information.

## Design contest for Glenview students

**G**lenview students in Kindergarten through 12th grade can vie for cash prizes and honors by submitting designs for the Glenview 1987 vehicle sticker.

To enter, make a drawing of some aspect of Glenview life. For example, depict a facet of the annual street sale, the 4th of July celebration, the Naval Air Station, The Grove, our award-winning schools, the Forest Preserve trails, the Village Hall, the Park District office, or anything else of local interest that appropriately represents the spirit of the village.

Bring your drawing to the Village Manager's office, 1225 Waukegan Road (lower level), no later than 5pm Thursday, January 15, 1987.

### Here are the rules:

- You must be a Glenview resident.
- You must be currently enrolled in grades K through 12.
- Your drawing must be on paper or card stock measuring  $8\frac{1}{2}$  by 11 inches.
- Your drawing must have no more than 4 colors, including the background.
- Your name, address, and phone number must be plainly written or printed on the back.
- Only one drawing per participant will be accepted.
- Entries received after 5pm January 15 will not be eligible.
- Entries become the property of the Village of Glenview.

Judging will be done by a panel of Glenview residents, and the decision of the judges will be final. First Place winner receives \$100 cash; 2 runners up receive \$25 each; 7 ribbons will be awarded to the other top 10 finalists.

**YOU COULD WIN!** Besides getting a prize, you may see your drawing reproduced on the windshield of every car in Glenview for a whole year!

And if you are the First Place winner, your drawing and your photograph will appear on the front page of this newsletter. So let's get started right away on those drawings!

**DONATE BLOOD** at the Blood Center of Northern Illinois, 1255 North Milwaukee Ave., Glenview, Monday-Thurs- day, noon-8pm; Friday, 9am-2pm; Saturday, 8am-1pm. Call 298-9660 for appointments.



**THE GLENVIEW SENIOR CENTER is at 901 Sherman Road, with many programs and free services available. Call 724-4793 for more information about any of the activities listed:**

**PLAY BINGO** at the center Monday, Dec. 15, at 10am.

**WOMEN'S INVESTMENT** class meets Tuesday, Dec. 16, at 10:30am.

**THE SENIOR CENTER WILL CLOSE** Thursday and Friday, Dec. 25 and 26, for Christmas, and Thursday, Jan. 1, for New Year's.

**RULES OF THE ROAD**, free refresher course for drivers, will be offered on Wednesday, Jan. 14, 1-3pm. Register in advance at the center.

**NAIL SCULPTURE**, at reduced rates by a licensed podiatrist, will next be offered Monday, Jan. 19, 10am-noon. Call in advance for an appointment.

**THE GLENVIEW SR. CITIZEN** Commission meets monthly at the Village Hall, 1225 Waukegan Road, at 9am. As at all official meetings of village bodies, the public is welcome. Next meeting: Monday, Jan. 19.

**MEN'S PROGRAMS** (open to all male retirees), resume in February.

**20% DISCOUNTS** are offered to ages 65+ enrolling in Glenview Park District winter classes (brochet, knit, quilt, current events, Great Decisions, exercise, investments, etc.). The Senior Center also offers free programs — call for information.

#### **REGULAR EVENTS:**

**Counseling**, Tuesdays, 10am-noon. ... **Community Advisor**, Thursdays, 11am-noon. ... **Free Blood-Pressure Tests** (open to the public), Thursdays, 11am-noon. ... **Visually-Impaired Club**, first Friday every month, 1pm ... **Information desk**, open 5 days a week until 4pm for assistance, referral, senior benefit books, discount sheets; call for information. ... **Seniors host** at the Historical Society first and second Sundays of the month, 2-5pm.

**APPLY NOW FOR** expanded Pharmaceutical Assistance, which, as of January 1, will cover medicines for arthritis and insulin and syringes for diabetes. (The program formerly covered†

### **The Glenview Newsletter**

Published monthly since 1967

by

The Village of Glenview  
1225 Waukegan Road  
Glenview IL 60025

724-1700

Copyright © 1986

(No reproduction

without written permission  
and credit line)

#### **VILLAGE OFFICIALS**

**President** ..... James W. Smirles  
**Clerk** ..... Katherine G. Apert  
**Trustees** ..... Robert Browne  
                                Charles K. Esler, Jr.  
                                Scott J. Helton  
                                Ronald V. Norene  
                                Delta Brady Stowe  
**Manager** ..... Lowell Scott Well  
**Asst. Mgr.** ..... Craig G. Anderson  
**Asst. to the Mgr.** ..... Joe Wade

Editor ..... Mimi Chan

Printing services  
by the Glenview Fire Department

only heart and blood-pressure medicines.) Those eligible for assistance must have annual incomes no higher than \$14,000. (ID cards will be received later in the year.) The Department of Revenue mails information to Circuit Breaker recipients. If you have questions, call (217) 782-6850 or (toll free) 1-800-732-8866.

**TTD (TELECOMMUNICATION DEVICE for the Deaf)** now reaches the Illinois Department on Aging toll-free number, 1-800-252-8966, weekdays from 8:30am to 5pm. Call to find senior centers, meals, transportation programs, and access information about in-home or adult day care.

**A RESIDENTIAL** affordable payment program allows households to keep primary and secondary utility services by paying 12% of household income. Those with regulated gas or electric service qualifying for IHEAP (Illinois Home Energy Assistance Program) are eligible. Call the center for full information.

**CEDA HOME WEATHERIZATION**, to help homeowners conserve energy, is available to applicants who meet federal income guidelines. Call CEDA, (435-6964), or Lois Melvojn (446-8750 or 724-4793) for more information.

**AARP 1987 LEGAL RIGHTS** calendar, explaining laws affecting older Americans (patients' rights, leases, trusts, etc.) are \$5.95 by check or money order payable to LCE, Inc., from Legal Rights Calendar, P.O. Box 19269-L, Washington DC 20036.

### **Park District events**

**FLOOR HOCKEY** for grades 1-3 and 4-6 starts in late January; register at elementary schools or Park District Office (1930 Prairie St.) Dec. 15-18. Grades 1-3 get instruction; games at Pleasant Ridge School. Grades 4-6 (separate leagues for boys and girls) have 6 weeks of play at Lyon School. Fee for each program: \$13.

**MELLIKAN PUPPETS** perform "The Night before Christmas" and "The Shoemaker and the Elves" for ages preschool through grade 6 and parents on Monday, Dec. 22, 10:30am, at Rugen Center, 901 Sherman Rd. Admission: \$2 at door.

**OPEN GYM** for schoolagers and adults at Springman Junior High, Dec. 22, 23, 26, 30, and Jan 2. Hours for grades 3-8, 8 to 11am; high schoolers and adults, 11am-3pm. Park District supervisors in attendance; participants please bring their own basketballs.

**HOLIDAY CRAFT AND GIFT WORKSHOP** for grades 1-6, Tuesday, Dec. 23, 9am-4:30pm, Glenview Ice Center, 1851 Landwehr Rd. Admission free; projects range from 20¢ to \$2.50; no registration required. Children may come anytime, make gifts, and phone home for rides when finished.

**PUPPY TRAINING** begins Jan. 8 at Roosevelt Pool building, with 8 weeks of classes on Thursdays, 7-8pm; applications now being taken. Dogs must be between 10 weeks and 6 months old and have had Parvo and DHL shots; owners must be 10 and older. Fee: \$30 for 8 weeks.

**JR. HIGH ACTION SPECIAL EVENTS** nights are Jan. 9 and Feb. 6. Please note that the dance is on Friday, Jan. 16 (not as listed in the Fall-Winter brochure). Grade 7 and 8 students may join Junior High Action by buying membership IDs for \$1 each (weekdays, 9am-5pm) and supplying wallet-size photos. Admission to events is †

### **Snow on the way**

No parking is allowed on village streets between 2 and 6am, from 12:01am Monday, December 1, through midnight March 31, 1987. Please warn family members and guests of the restriction.

When it snows, village crews begin clearing streets in the early morning hours, and parked cars make the job impossible.

Even if no snow falls during the night, cars may be towed if found violating the ordinance (#2260, posted on all major thoroughfares entering Glenview).

If you need off-street parking for house guests during the holidays, please make arrangements as soon as possible. If you have an exceptional need for street parking, please call the Village Manager's office to see whether special arrangements can be made.

**DO NOT SHOVEL, BLOW OR PLOW SNOW onto any part of a public street or sidewalk.** Instruct those hired for snow removal that it is illegal in Glenview to cover or block a public thoroughfare with snow. Such blockage creates hazards for both pedestrians and motorists.

Please remove snow and ice from your sidewalks promptly. Remember that pedestrians, including mail carriers, children and seniors, use them every day.

by membership, ID + fee (depending upon the event); to dances, \$2 at door.

**SPRING AYSO SOCCER** registration: Saturdays, Jan. 17 and 24, 10am-2pm, and Monday, Jan. 26, 6-9pm, at Rugen Center, 901 Sherman Rd. Fees: \$15 for fall season participants; \$28 for others. This is the only registration for AYSO's April-May soccer season, cosponsored by the American Youth Soccer Organization and the Glenview Park District.

**OUTDOOR SKATING RINKS** and sledging hills may be used whenever the weather permits. Rinks are at Cunniff, Elm, Flick, and Roosevelt Parks; separate hockey areas (with nets) at Roosevelt and Elm; sledging hills at Elm and Flick. Hours: weekdays, 4-8pm; weekends and holidays, 1-8pm.

**SERIES OF FIVE GOLF LESSONS** for adults and juniors; registration open at the Glenview Park Golf Club pro shop, first-come, first-served. Equipment available, but students are advised to have their own. For more call the golf club, 724-0250.

**COLD WEATHER** can trigger heart attack, frostbite, asthma, and broken bones from falls, and is especially risky for the elderly. Hypothermia (a deep drop in body heat) can be fatal. Special care should be taken to keep warm at night. Body temperature below 95F requires medical help for survival — call paramedics immediately.

**THE WATER DEPARTMENT** advises that meters behind glass blocks cannot be read accurately unless the glass is clean and unobstructed. It's also a good idea to compare inside meter readings with outside (remote) readers to catch discrepancies early. Remote readers, enabling readings to be made without entering houses, are available free. Installation takes about an hour. If you would like one, please call the Water Department, 724-1700 X259.

# Programs at Glenview's Public Library

## For adults:

Wed., Dec. 17, 7:30pm (Maynard Room) — "Israel, Land of the Bible," travelog slide-lecture by Ransome Slayton.

Mon., Jan. 5, 12:30pm (Conference Room) — "The Auerbach Will," by Stephen Birmingham; book discussion.

Mon., Jan. 12, 7:30pm (Maynard Room) — "Stones for Ibarra" by Harriet Doerr; book discussion.

Fri., Jan. 16, 2 and 7pm (Maynard Room) — "The Color Purple" (feature film) rated PG-13; repeated Sat., Jan. 17, 2pm. Stephen Spielberg directs Whoopi Goldberg, Oprah Winfrey, Danny Glover, and Adolph Caesar. Tickets for all 3 showings available at the information desk Fri., Jan 2. (Doors open 15 minutes before each showing.)

**COMING:** Jan. 21, **Puerto Rico, Spanish USA;** Jan. 26, **Diet Cookery;** Jan. 31, **tours of Chinatown and the Loz-zadro Museum.** Information available at the information desk.



## Village Board action:

**Abated 1986 tax levies:** \$4,425,000 in corporate-purpose bonds, series 1977 (water-system acquisition); \$5,700,000 in corporate-purpose bonds, series 1979 (water-system improvements); and \$3,100,000 in general-obligation library bonds, series 1984. . . . **Rezoned** the southeast corner of Milwaukee Avenue and Glenview Road to R1-8 for a nursing center. . . . **Extended conditional uses** (B-3 in B-2 zone) at 241 and 1610 Waukegan Road, for additions to auto dealerships. . . . **Restricted parking** on County Lane between 8 and 10am weekdays, from north of Overlook Drive to west of the northeast corner of Locust and County Lanes. . . . **Approved** a 1-lot subdivision on Wildwood Lane between Glenwood Avenue and Woodlawn Road, with enough improvement of Highland Terrace to allow access of emergency vehicles. . . . **Approved purchase** of a used car (\$7,500 maximum) for Public Works use. . . . **accepted** the solid-waste proposal of the Northwest Municipal Conference. . . . **Approved** the usual arrangement with the Village of Golf for street selling. . . . **Welcomed Robert Browne** to the Village Board as an appointed trustee, to serve the unexpired term of James Weiss (resigned).

**ROBERT BROWNE**, former chairman of the Plan Commission, has been appointed Village Trustee to serve the unexpired term of James Weiss. Browne, a partner in a Chicago law firm, is a graduate of the University of Wisconsin and the University of Notre Dame law school. He served 6 years on the Plan Commission. He and his wife are the parents of three.

## APPLICATIONS ARE BEING TAKEN

for state Home Energy Assistance for low-income households qualifying on one of the following grounds: 1- Disconnected heating service, 2- At least one handicapped household member; 3- At least one household member 60 or older. **Low-income guidelines** (for the past 90 days): Not more than \$1,675 for a family of 1; \$2,263 for 2; \$2,850 for 3; \$3,438 for 4; \$4,025 for 5; \$4,613 for 6; \$5,200 for 7. **Call 328-5166**, Neighbors at Work CEDA Affiliate, for more information.

## For children:

Sat., Dec. 22, 2pm — **One-hour film program:** "Cannonball," "Squirrel on My Shoulder," and "Tender Tale of Cinderella Penguin" for preschool through grade 3. Tickets available Dec. 15.

Tues., Dec. 23, 2pm — **Chuck Field** (professional ventriloquist) and **Ziggy** (15-pound dummy and working partner) for kindergarten and older. Tickets available Dec. 16.

Sat., Dec. 27, 2pm — "**Alice in Wonderland**," classic film for all ages (75 min.). Tickets available Dec. 20.

Mon., Dec. 29, 2pm — "**Murphy's Paw Puppet Theater**" (40 min.) for preschool and older. Tickets available Dec. 22.

Tues., Dec. 30, 2pm — "**Sleeping Beauty**" (74-minute film) for all ages. Tickets available Dec. 23.

Sat., Jan. 3, 2pm — "**The Cat from Outer Space**" (87-minute comedy film) for all ages. Tickets available Dec. 27.

Sat., Jan 10, 9am — **Registration for Age 2 Storytime**, for child and parent or babysitter, Mondays, 9:45-10:15am, or 10:30-11am. Session I, Feb. 2 - March 2; Session II, March 9 - April 13; enroll for only one. (For Glenview residents only.)

Sat., Jan. 10, 9am — **Registration for Session II Preschool Storyhour.** Ages 3-5 on Tuesdays or Wednesdays, 10am or 1:30pm, for 9 weeks, starting Feb. 3 and 4. Children may be registered only by parents or relatives who are Glenview residents with Glenview library cards.

## Finance honored for 4th time

The Government Finance Officers Association of the U.S. and Canada has given its Certificate of Conformance in Financial Reporting to the Village of Glenview for the 4th consecutive year.

The GFOA is a nonprofit professional association serving 9,500 government finance professionals. Entries are judged by impartial finance officers, CPAs, educators and other financial experts. The certificate helps to keep Glenview's bond rating high.

When a certificate is given, a **Financial Reporting Achievement Award** is presented to the person responsible for accounting and reporting procedures. **Dennis M. Lauer**, Glenview Finance Director, has now received this award for the 4th consecutive year.

We congratulate him and the staff of the Finance Department for continuing excellence in professional practice, and for bringing Glenview into the winners' circle for the 4th time.

This year Lauer is also president of the Illinois Government Finance Officers' Association.

**DURING SEVERE WEATHER**, Glenview police advise drivers in car accidents (provided there are no injuries and cars are operable) to come to the Public Safety Building, 1215 Waukegan Road, to fill out accident reports. (Patrol officers may be too busy during extremely bad weather to handle anything but emergency calls.)

## Disabled organize

The recently organized North Suburban Chapter of the Illinois Coalition of Citizens with Disabilities covers the north and northwest Chicago suburbs, formerly not represented by the coalition.

The organization strives for social and political betterment of disabled persons and dissemination of information concerning issues affecting them. You need not be disabled to join. For more information call Donna Anderson, 297-2510.

In order to direct its efforts, the coalition needs to know the issues you think should be addressed. Please fill out the following questionnaire and return, either by mail or the postage-free drop box at the Village Hall, no later than January 15.

To:  
Kerry O'Shaughnessy  
Glenview Health Department  
1225 Waukegan Road  
Glenview IL 60025

Are you disabled? YES \_\_\_ NO \_\_\_

Do you know someone who is?

YES \_\_\_ NO \_\_\_

Do you/they have your/their own means of transportation?

YES \_\_\_ NO \_\_\_

If NO, what do you/they use?

PUBLIC \_\_\_ PARATRANST \_\_\_

DIAL-A-RIDE \_\_\_ OTHER (specify): \_\_\_\_\_

Can you use public transportation?

YES \_\_\_ NO \_\_\_

Please list any public buildings you know that are inaccessible to disabled persons:

\_\_\_\_\_

\_\_\_\_\_

\_\_\_\_\_

In what township do you live?

\_\_\_\_\_

\_\_\_\_\_

Comments: \_\_\_\_\_

\_\_\_\_\_

\_\_\_\_\_

\_\_\_\_\_

\_\_\_\_\_

\_\_\_\_\_

\_\_\_\_\_

\_\_\_\_\_

\_\_\_\_\_

\_\_\_\_\_

\_\_\_\_\_

\_\_\_\_\_

\_\_\_\_\_

\_\_\_\_\_

\_\_\_\_\_

\_\_\_\_\_

\_\_\_\_\_

Thanks for your help in filling and returning this questionnaire.



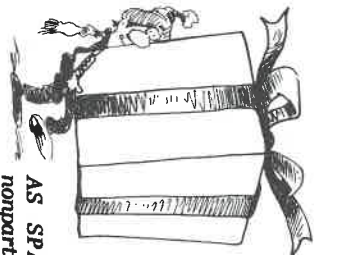

# COMMUNITY BULLETIN BOARD:



# HAPPY NEW YEAR!

AS SPACE PERMITS, we print items of nonsectarian, nonpartisan, non-profit content that are of general community interest. Those for January 15 through February 15 should reach the Village Hall or the editor by 10am MONDAY, DECEMBER 22.

**ELVES WANTED!**  
SEASONAL WORK  
APPLY  
S. CLAUS  
EMPLOYMENT  
422 PAsAdm54



**POSTAL SERVICE** during the holiday season: Window hours extended until 6:30pm Mondays and Fridays; a special window open at 7:30am for package pickup and stamps only. Stamps also available at 1919 Prairie Street and 1809 Waukegan Road from 6am to 11pm daily with bill changers for \$15 and \$55 available. Special Delivery and Express Mail continue during the holidays; no deliveries on Christmas or New Year's Days.

**HOLIDAY HAZARDS** include poisonous berries of holly and mistletoe, Jerusalem cherries, angel hair (spun glass), and disk batteries (found in musical greeting cards, certain toys, and calculators). These items are highly toxic if eaten or chewed. Keep them out of reach of children and pets.

**SLIM AND TRIM CLASSES** will not meet December 23 or 30.

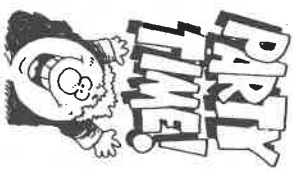

## CHRISTMAS AND NEW YEAR'S DISPOSAL PICKUPS

**ACE** — Thursday and Friday customers serviced Fridays, 12/26 and 1/2.

**BEST** — Thursday customers serviced Mondays, 12/22 and 12-29.

**BROOKS** — Customers notified.

**BROWNING-FERRIS** — Customers serviced one day late between Dec. 25 and Jan. 2.

**RTIEWAY** — Thursday customers serviced Fridays, 12-26 and 1-2.

**THE ADULT DAY-CARE CENTER** at Avoca West School, 235 Beech Drive, takes those unable to stay at home alone during the day. Bus service is available within a 5-mile radius. Tours of the day-care center are on Tuesdays, 10am-noon, and 1-3pm. Call Renee Goodman of Parkside Human Services, 998-7473.

**NURSING SCHOLARSHIPS** funded by Kraft, Inc., and the Glenview Registered Nurses' Association are offered to local residents actively engaged in studies leading to R.N. or other advanced degree. Application deadline is Feb. 15. For more call Phyllis Bangart, 967-9370.

**TWO FREE PROGRAMS** are offered to Glenview residents by the Fire Department at the station, 1815 Glenview Road. Please register in advance by calling 724-2141: **First Aid** — Tues., Dec. 16, 7 to 9pm (adults); and **Babysitting** — Sat., Dec. 20, 9am to 2:30pm (ages 9+); please bring a brown-bag lunch, pencil, and notebook.

**GLENVIEW JAYCEES CHRISTMAS TREES** (balsam and Scotch pine) are sold on the OLPH parking lot west of Waukegan Rd., 5-9pm Mondays through Thursdays; 4-9pm Fridays; 9am-6pm Saturdays and Sundays.

**WEIGHT-REDUCTION** information and registration will be held Tuesday, Jan. 13, 7pm, enclosed lobby, Glenbrook Hospital, conducted by community dietitian Donna Gavin. Courses begin Jan. 20 and 22, Tuesday classes meeting 7-8:30pm, Thursday classes 10-11:30am, for 9 weeks. Topics include behavior modification, calorie reduction, nutrition, dining out, exercise, and stress management. Cost is \$90 and physician approval is required. Call 729-8970 for more information.

**OVERNIGHT PARKING OF COMMERCIAL VEHICLES** in residential areas is prohibited in Glenview, unless such vehicles are garaged. Please observe the law.

**NEW TRADITION CHORUS** of Northbrook SPBSQSA presents holiday concerts Friday, Dec. 19, 8pm, and Saturday, Dec. 20, 3pm and 8pm, at Glenbrook South High School. Tickets \$8 each, all seats reserved.

**AN AL-ANON INFORMATION** meeting will be held Wednesday, January 7, 7:30pm, at St. David's Church, 2410 Glenview Road. Glenview Al-Anon family groups invite the public to attend. Refreshments will be served.

**MAINE-NORTHELD LITTLE LEAGUE** Baseball registration will be held Sundays, Jan. 11 and 18, 11am-2pm, at the Glenview Ice Center. New registrants must bring birth certificates. Tax-deductible donations are due at sign-up time: For first child in family, \$75; each additional child \$35. (Prizes for all children.) Leagues include Instructional "Triple A" (ages 7-8), Minors (8-11), Majors (10-12), and Seniors (13-16). Open to both girls and boys, this is the area's only official Little League baseball program from Williamsport, Pennsylvania.

**THE CIVIL AIR PATROL** offers cadet and senior memberships for flight, fun, adventure — and maybe for a career. To find out more call Technical Sgt. Bill Snell at Glenview Naval Air Station, 657-2300.

SUN	MON	TUES	WED	THUR	FRI	SAT
DECEMBER 14	15	16	17	18	19	20
21	22	23	24	25	26	27
28	29	30	31			
4	5	6	7	8	9	10
11	12	13	14	15	16	17